

# AB 081610



Sample image

**Order symbol :** AB 081610

**Product nr :** 7083640

**Description :** Enclosure, ABS

**Remarks :** Grey cover

**EAN :** 6418074003522

**El. number :**

- Finland : 3423482
- Denmark : 8212003389
- Sweden : 2508734

**Including :** Base with screws for mounting plate/DIN-rail. cover with PUR gasket and stainless steel cover screws.

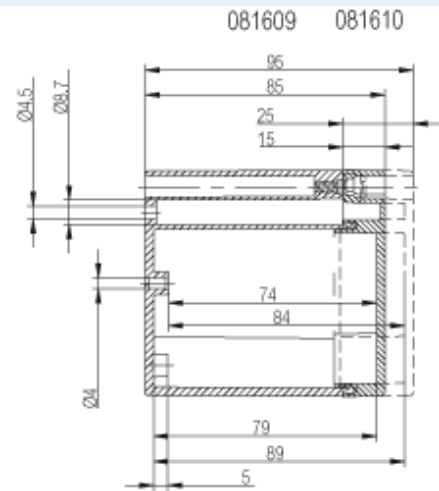
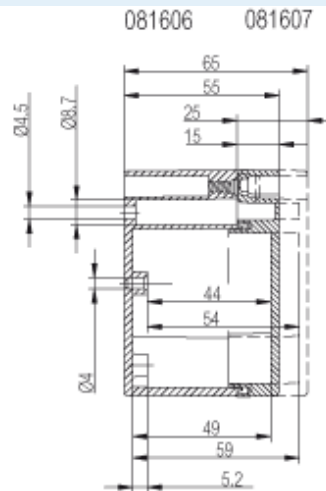
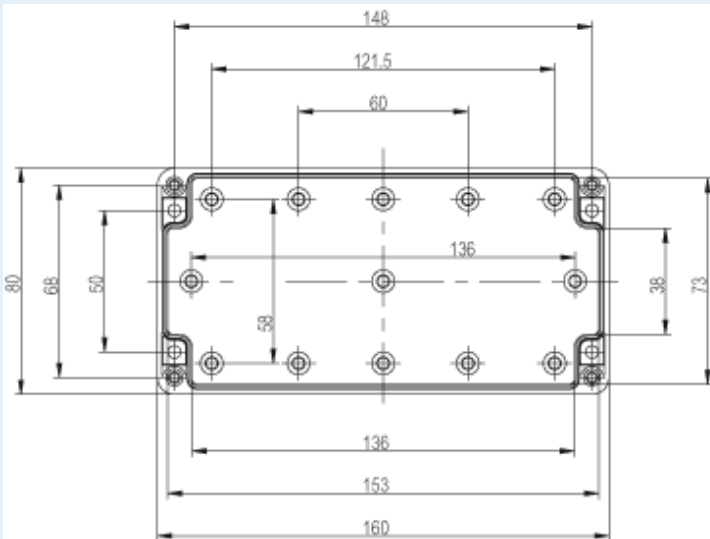

Dimensions :	Height	Width	Depth
mm :	80	160	95
inch :	3.15	6.3	3.74

**Materials :**

Material : ABS

**Accessories :**

- TRH 1216 DIN-35 Mounting rail, for enclosures: (146 x 35 x 7)
- TRM 0816 DIN-15 Mounting rail, for enclosures: (146 x 15 x 5)
- TM 0816 Mounting plate, for enclosures: (71 x 134 x 1.5)
- TH A Grey plastic hinges (2 pcs)

Base colour : RAL\_7035  
Cover colour : RAL 7035 -light grey  
Gasket material : Polyurethane

(30 x 20 x 12)  
TRM 0808 DIN-15 Mounting rail, for enclosures:  
(68 x 15 x 5)

**Temperatures :**

Temperature °C (continuous) : -40 ... 60  
Temperature °F (continuous) : -40 ... 140

**Ratings :**

Ingress protection (EN 60529): IP66; IP67;  
Impact Resistance (EN 62262): IK07;  
electrical\_insulation : Totally insulated  
Halogen free (DIN/VDE 0472, Part 815) : Yes  
UV resistance : -  
Flammability Rating : UL 94 HB  
Glow Wire Test (IEC 695-2-1) °C : 650C

**Certificates :**

SGSFimko\_EURONORD